

# Push-Lock Connectors

## ATTACHABLE

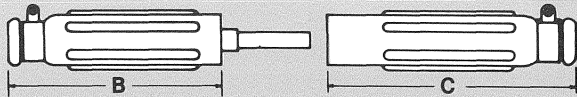

## MOLDED-TO-CABLE

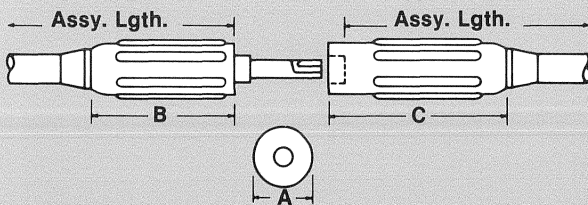

## PLUG

## WITH COVER

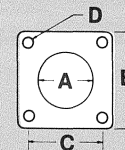
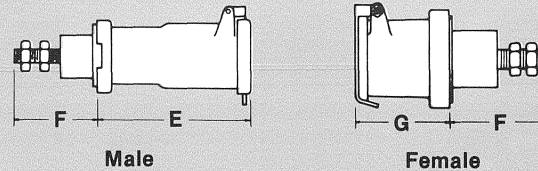

## RECEPTACLE

Electrical Data		Dimensions (Approx Inches)			Part Numbers			Part Numbers									
Max. AWG	Max. Amp.	A	B	C	Assy. Lgth.	Male	Female	Male	Female		A	B	C	D	E	F	G
<b>Attachable 600 volt</b>																	
2	110	1 <sup>3</sup> / <sub>8</sub>	4 <sup>3</sup> / <sub>4</sub>	5 <sup>5</sup> / <sub>16</sub>	Attach.	X8168-3	X8168-2	X8168-14	X8168-10	Covered	1 <sup>1</sup> / <sub>4</sub>	1 <sup>1</sup> / <sub>2</sub>	2	7 <sup>7</sup> / <sub>32</sub>	4 <sup>7</sup> / <sub>16</sub>	2 <sup>7</sup> / <sub>16</sub>	2 <sup>7</sup> / <sub>16</sub>
2/0	175	1 <sup>5</sup> / <sub>8</sub>	5 <sup>7</sup> / <sub>16</sub>	6 <sup>3</sup> / <sub>8</sub>	Attach.	X8169-3	X8169-4	X8169-31	X8169-17	Covered	1 <sup>1</sup> / <sub>2</sub>	2	2 <sup>5</sup> / <sub>8</sub>	9 <sup>1</sup> / <sub>32</sub>	5 <sup>1</sup> / <sub>2</sub>	2 <sup>1</sup> / <sub>2</sub>	2 <sup>1</sup> / <sub>2</sub>
4/0	235	1 <sup>7</sup> / <sub>8</sub>	6 <sup>5</sup> / <sub>16</sub>	7 <sup>7</sup> / <sub>8</sub>	Attach.	X8170-1	X8170-2	X8170-36	X8170-35	Covered	1 <sup>5</sup> / <sub>8</sub>	2	2 <sup>5</sup> / <sub>8</sub>	9 <sup>1</sup> / <sub>32</sub> M 7 <sup>7</sup> / <sub>32</sub>	5 <sup>1</sup> / <sub>2</sub>	2 <sup>1</sup> / <sub>2</sub>	2 <sup>7</sup> / <sub>8</sub>
4/0	235	1 <sup>7</sup> / <sub>8</sub>	6 <sup>3</sup> / <sub>16</sub>	9 <sup>9</sup> / <sub>16</sub>	Attach.	X8567-10	X8567-18		X8567-23	Covered	3 <sup>7</sup> / <sub>16</sub>	3	4 <sup>1</sup> / <sub>16</sub>	9 <sup>1</sup> / <sub>32</sub>		8 <sup>5</sup> / <sub>8</sub>	1 <sup>1</sup> / <sub>16</sub>
						<b>Male contact shrouded</b>											

For welding applications, the above will carry the same load as those listed below for corresponding wire sizes.

## Molded to cable up to 125 volt welding

2/0	375	1 <sup>1</sup> / <sub>8</sub>	4 <sup>3</sup> / <sub>16</sub>	5 <sup>3</sup> / <sub>16</sub>	45"	X8165-4	X8165-5	X8169-31	X8169-17	Covered	1 <sup>1</sup> / <sub>2</sub>	2	2 <sup>5</sup> / <sub>8</sub>	9 <sup>1</sup> / <sub>32</sub>	5 <sup>1</sup> / <sub>2</sub>	2 <sup>1</sup> / <sub>2</sub>	2 <sup>1</sup> / <sub>2</sub>
4/0	550	1 <sup>3</sup> / <sub>8</sub>	4 <sup>3</sup> / <sub>8</sub>	5 <sup>1</sup> / <sub>2</sub>	45"	X8166-6	X8166-3	X8170-36	X8170-35	Covered	1 <sup>5</sup> / <sub>8</sub>	2	2 <sup>5</sup> / <sub>8</sub>	9 <sup>1</sup> / <sub>32</sub> M 7 <sup>7</sup> / <sub>32</sub>	5 <sup>1</sup> / <sub>2</sub>	2 <sup>1</sup> / <sub>2</sub>	2 <sup>7</sup> / <sub>8</sub>

## Molded to cable 5000 volt

2	110	1 <sup>3</sup> / <sub>8</sub>	4	4 <sup>1</sup> / <sub>4</sub>	24"	X8173-1	X8173-2		X8173-13	Covered	1 <sup>1</sup> / <sub>2</sub>	2 <sup>5</sup> / <sub>8</sub>	2	9 <sup>1</sup> / <sub>32</sub>	2 <sup>1</sup> / <sub>32</sub>	2 <sup>1</sup> / <sub>2</sub>
2/0	175	1 <sup>3</sup> / <sub>8</sub>	4 <sup>3</sup> / <sub>8</sub>	5 <sup>1</sup> / <sub>4</sub>	18"	X8174-4	X8174-3									

NOTE: Refer to price list for identification of stock items.